

FXN 156 | FLEXIBLE NEON

SLEEVE FRONT CONNECTOR

Please ignore these steps if the front connector has been assembled before delivery.

Note:

1. Never wet the assembly units or assemble with wet hands.
2. Please use the tools correctly.
3. Please pay attention to personal security when using tools.
4. Repeated assembly or reuse of the connector may result in waterproof failure.

1. Components of Front Connector

Note:

The light ends are marked with either an 01 or an 02. Always make sure to use an identically labeled connector for the appropriate direction.

2. Tools

3. Installation Steps

3.1 Placing PC Cover

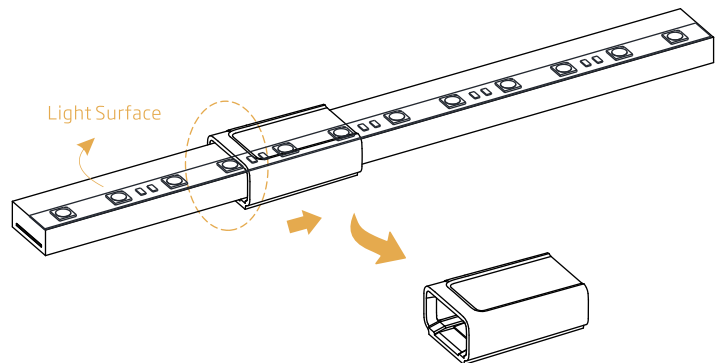
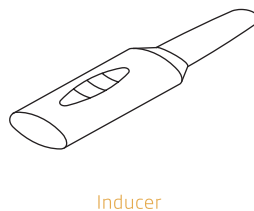
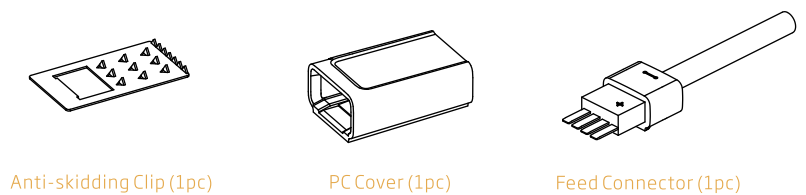
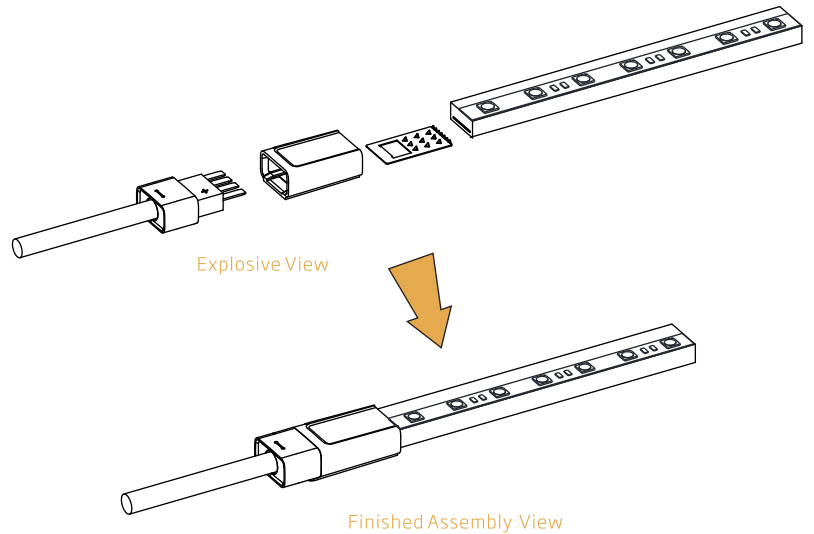

FXN 156 | FLEXIBLE NEON

SLEEVE FRONT CONNECTOR

3.2 Inducing a Cavity for Feed Connector

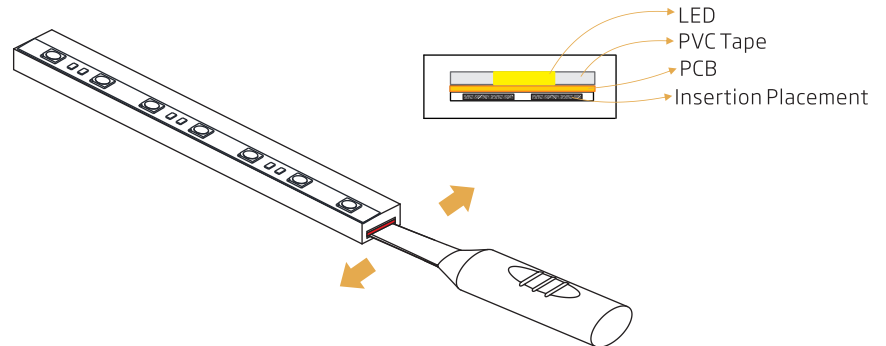

NEVER insert into the front side (LED side) of the PCB

Insert the inducer to the backside of PCB around 10 ≈ 12, move the inducer right and left 3 ≈ 5 times gently to create a small cavity.

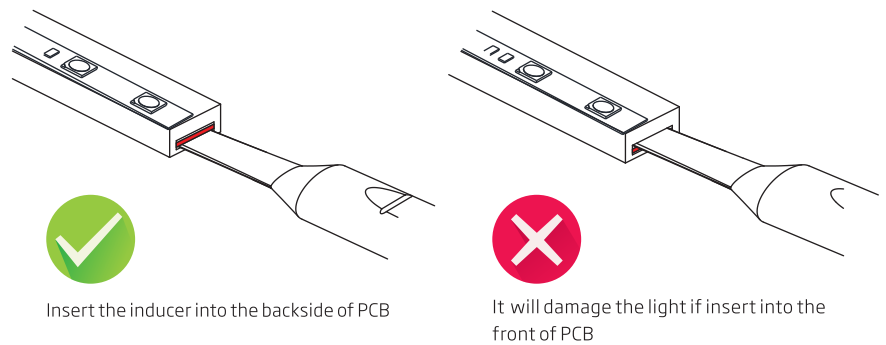

Insert the feed connector pins into the cavity that you created with the inducer (backside of PCB)

3.3 Insert the Feed Connector

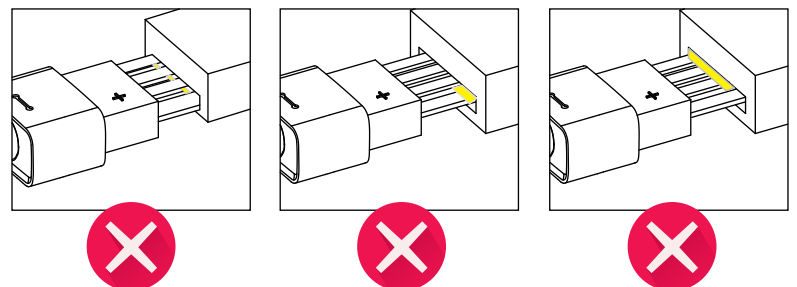
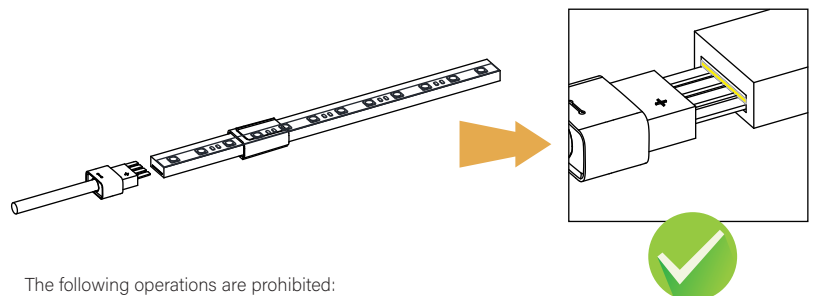

Insert into the front side of the PCB

Insert crosswise into the PCB

Insert crosswise into the PCB

FXN 156 | FLEXIBLE NEON

SLEEVE FRONT CONNECTOR

3.4 Installation of Anti-Skidding Clip

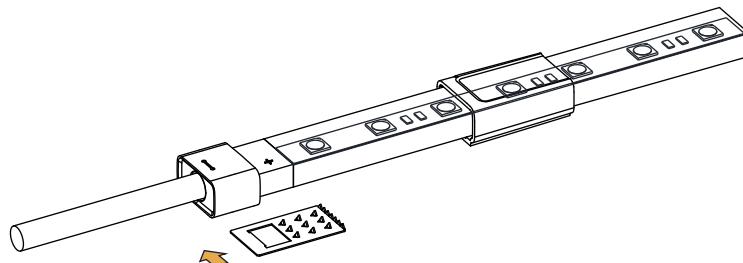

Place the anti-skidding clips to the feed connector with toothhead side towards light.

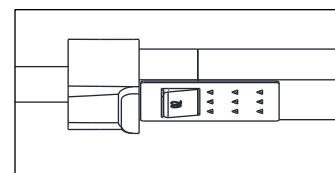
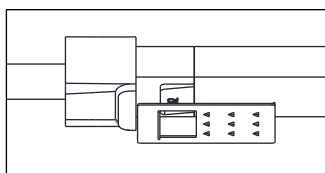

3.5 Slide back the PC Cover to cover the anti-skidding clip completely.

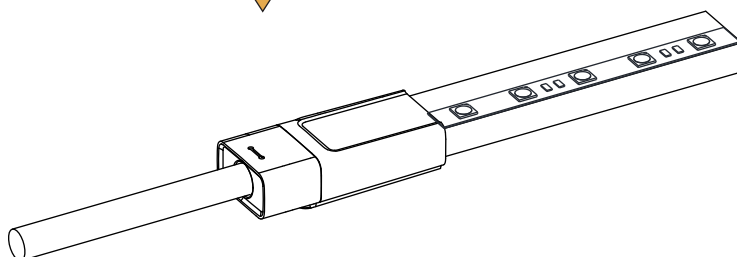
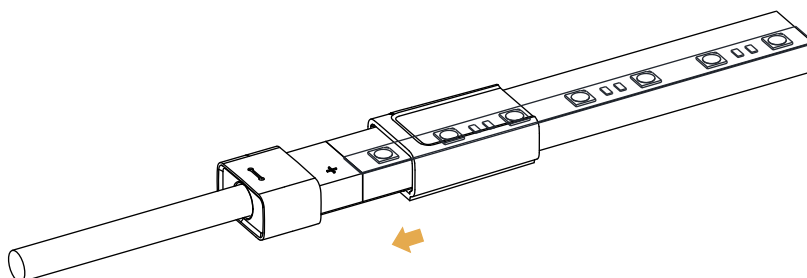

Please energize the light to check its functionality after connector assembly.

FXN 156 | FLEXIBLE NEON

SLEEVE END CAP

Please ignore these steps if the end cap has been assembled before delivery.

Note:

1. Never wet the assembly units or assemble with wet hands.
2. Please use the tools correctly.
3. Please pay attention to personal security when using tools.
4. Repeated assembly or reuse of the connector may result in waterproof failure.

1. Components of End Cap

2. Installation Steps

2.1 Placing Shading Sheat

2.2 Insert the PC Cover

Please check its OK

